

Gimbal Mount Installation Guide

Thank You

Thank you for choosing Humminbird®, the #1 name in fishfinders. Humminbird® has built its reputation by designing and manufacturing top-quality, thoroughly reliable marine equipment. Genuine Humminbird® accessories offer the opportunity to upgrade and expand the capabilities of your Humminbird® product.

Overview

Use the gimbal bracket to mount the **Humminbird® Multi-Function Display (MFD)** so that it can be tilted for easy viewing. The installation kit includes the following supplies*:

- (1) Gimbal bracket
- (2) Gimbal knobs
- (2) Urethane Washers
- (4) Flat Washers (1/4 [M6])
- (4) Split Ring Locking Washers (1/4 [M6])
- (4) Nuts (1/4-20, [M6x1])
- (4) Carriage Bolts (1/4-20, 2" [M6x1, 50 mm])

*Product supplies and features are subject to change without notice.

Supplies: In addition to the hardware supplied with your installation kit, you will need a powered drill and various drill bits, various hand tools, including a socket wrench, a marker or pencil, safety glasses, dust mask, and marine-grade silicone sealant.

NOTE: Your Humminbird® control head might not look exactly like the illustrations in this guide, but the control head will mount in the same way.

1. Planning the Mounting Location

To gimbal mount the Humminbird® MFD, pre-assemble the unit to plan the best mounting location.

NOTE: If you prefer to mount the Humminbird® MFD overhead, follow the instructions in this guide and install the bracket above the control head. Note that the front of the bracket has an extra hole in the center (see the illustrations **Optional Mount: Overhead** and **Gimbal Bracket**).

1. Place one urethane washer on one of the gimbal knobs, and then thread the knob and washer into the gimbal housing. Tighten the knob just enough so that there is adequate space to slide the control head into the openings on the arms of the bracket in the proceeding steps.
2. Repeat step 1 for the other side.

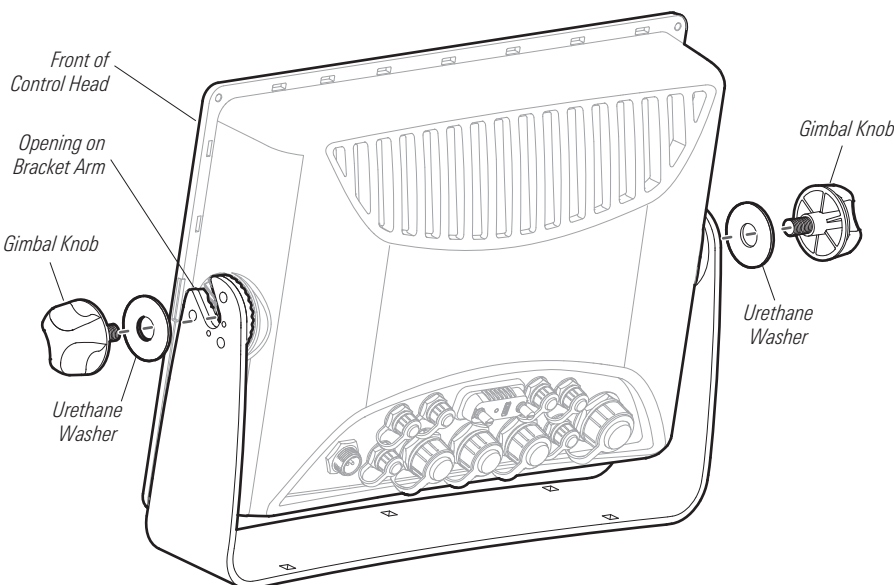

Optional Mount: Overhead

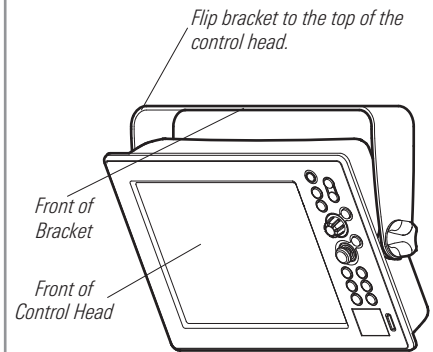

Gimbal Bracket

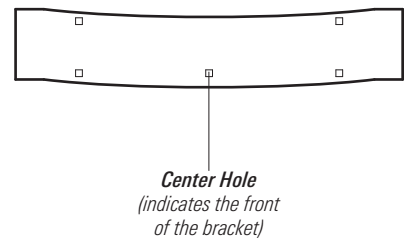

Gimbal Mount Installation Guide

531782-3_A

- Slide the control head into the arms of the bracket mount. The front of the bracket has an extra hole in the center (see the above illustration *Gimbal Bracket*).
- Hand-tighten the gimbal knobs to secure the control head to the bracket.
- Place the assembled control head in various locations to determine the best mounting location. Consider the following when choosing a mounting location:
 - There must be enough space (2 to 4 inches) behind the chosen location to drill a 1.5 inch (37.5 mm) hole for the cables to pass through.
 - The mounting surface must be adequately supported to protect the control head from excessive wave shock and vibration.
 - The chosen mounting area should allow for sufficient space so the control head can pivot through the full tilt range.
 - The mounting location should allow for visibility during operation, as well as easy installation and removal.
 - You must have access, either above or below the mounting surface, to pass the cables through to the control head.
- Test route the appropriate cables (GPS, power, accessory, etc.) to the control head mounting location. If the cables are too short for your application, extension cables are available. Contact our Customer Resource Center for information.

2. Installing the Gimbal Bracket

- After you have determined the mounting location, loosen the gimbal knobs and remove the control head from the gimbal bracket.
- Place the gimbal bracket in the chosen position on the mounting surface and mark the four carriage bolt locations using a pencil or center punch. The front of the bracket has an extra hole in the center (see the illustration *Gimbal Bracket Holes*).

CAUTION! Do NOT drill the center hole. Use the center hole to identify the front of the bracket only.

- Set the gimbal bracket aside and drill the four carriage bolt holes using a 9/32" (7.14 mm) drill bit.

NOTE: When drilling holes in fiberglass, start with a smaller bit and use progressively larger drill bits to reduce the chance of chipping the outer coating.

- Mark and drill a 1.5" (37.5 mm) diameter hole that will allow you to run the cables close to the mounting bracket. This hole should be centered approximately 2 to 4 inches from the back of the control head.

NOTE: You may want to insert a plastic cable grommet (not included) to smooth the hole edges and prevent damage to the cables.

- Traditional Mount:** Place the bracket onto the mounting surface aligned with the drilled holes and fill the holes with marine-grade silicone sealant. Insert the carriage bolts into the 4 mounting holes.

Overhead Mount: Place the bracket onto the mounting surface aligned with the drilled holes. Fill 1 hole with marine-grade silicone sealant. Insert a carriage bolt into the hole, and see step 6 to add the hardware to the carriage bolt. Repeat for the remaining 3 holes.

- On each bolt, add the hardware in the following order: flat washer, split ring washer, and nut (see the illustration *Mounting the Bracket*). Do not tighten completely until all four nuts are securely in place.
- Use a socket wrench to tighten each nut until the split ring washer flattens.

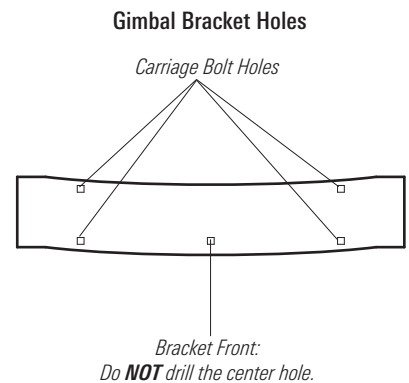

Gimbal Mount Installation Guide

531782-3_A

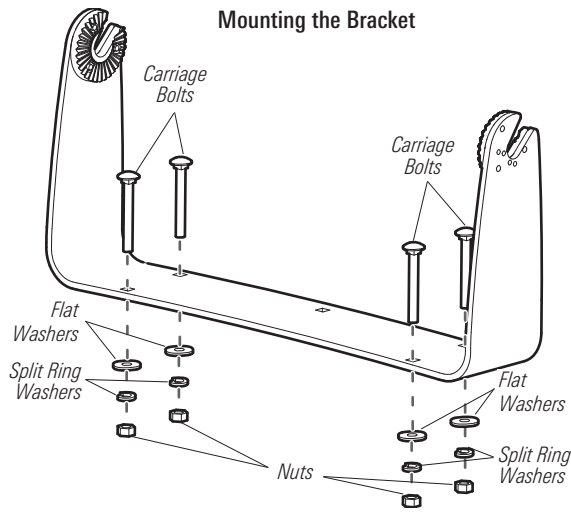

- Place the control head back onto the mounting bracket (see *Planning the Mounting Location* for details). Adjust the control head viewing angle as needed and tighten the gimbal knobs until the assembly is secured.

3. Route & Connect the Cables

- See the installation guides included with each hardware component to install power, GPS, and other optional equipment (AIS, radar, autopilot, and accessories). Route the cables to the control head.
- Pass the cables through the 1.5" (37.5 mm) hole, and connect them to the appropriate ports on the control head. Each port is labeled and the connectors are keyed to prevent incorrect installation.

NOTE: When the cables connect to the control head through the hole, leave enough cable slack to allow for the control head to pivot through its full tilt range. Extra cable slack will also help when connecting or disconnecting the cables.

- Hand-tighten the screw nut on each cable to secure the connection. Any unused ports should be covered with the port covers to prevent potential damage.
- Apply labels to the cables (optional). Use nylon cable ties (not included) to secure the cables and create a clean assembly.
- See the Humminbird® Operations Manual to configure the control head and confirm all connections.

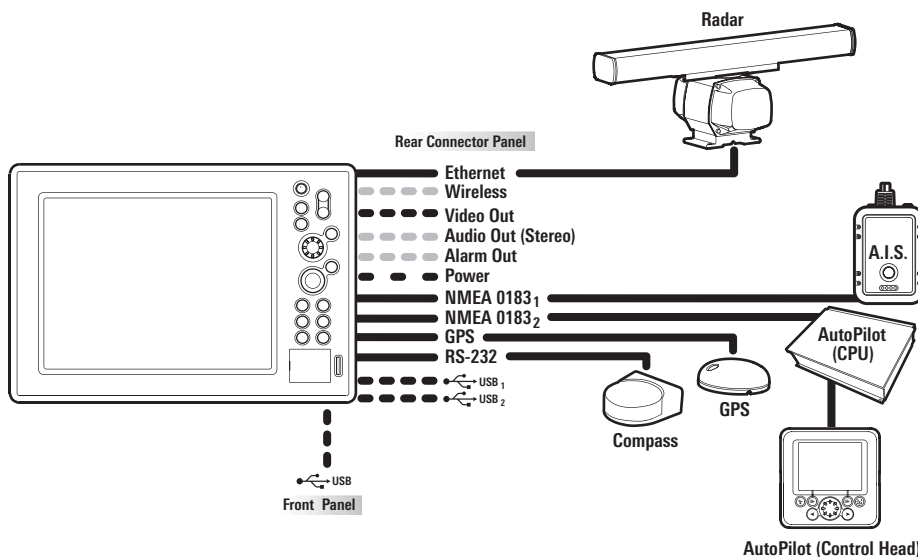

NOTE: Your control head might have a different configuration than the connections shown in this illustration. See your control head installation guide for details.

Routing the Cables

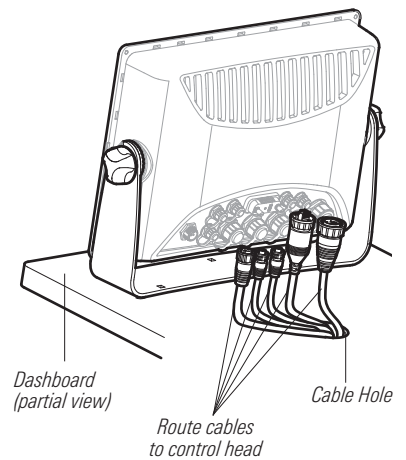

Securing the Cables (magnified view)

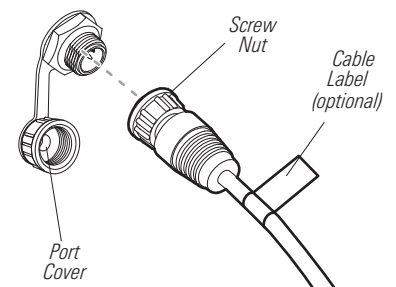

Gimbal Mount Installation Guide

531782-3_A

Contact Humminbird®

Contact the Humminbird® Customer Resource Center
in any of the following ways:

By Telephone

(Monday - Friday 8:00 a.m. to 4:30 p.m. Central Standard Time):

1-800-633-1468

By e-mail

(typically we respond to your e-mail within three business days):

service@humminbird.com

For direct shipping, our address is:

Humminbird

Service Department

678 Humminbird Lane

Eufaula, AL 36027 USA

WARNING! This device should not be used as a navigational aid to prevent collision, grounding, boat damage, or personal injury. When the boat is moving, water depth may change too quickly to allow time for you to react. Always operate the boat at very slow speeds if you suspect shallow water or submerged objects.

WARNING! The Multi-Function Display and all connected equipment should be installed by a Certified Marine Electronics Technician (CMET) or an authorized Marine Electronics Installer (MEI). See NMEA.org for details. Incorrect installation affects the system's performance, which affects the safety of the vessel and its passengers. If you have questions about the installation, please contact our Customer Resource Center.

WARNING! Disassembly and repair of this electronic unit should only be performed by authorized service personnel. Any modification of the serial number or attempt to repair the original equipment or accessories by unauthorized individuals will void the warranty.

WARNING! This product contains chemicals known to the State of California to cause cancer and/or reproductive harm.

ENVIRONMENTAL COMPLIANCE STATEMENT: It is the intention of Johnson Outdoors Marine Electronics, Inc. to be a responsible corporate citizen, operating in compliance with known and applicable environmental regulations, and a good neighbor in the communities where we make or sell our products.

WEEE DIRECTIVE: EU Directive 2002/96/EC "Waste of Electrical and Electronic Equipment Directive (WEEE)" impacts most distributors, sellers, and manufacturers of consumer electronics in the European Union. The WEEE Directive requires the producer of consumer electronics to take responsibility for the management of waste from their products to achieve environmentally responsible disposal during the product life cycle.

WEEE compliance may not be required in your location for electrical & electronic equipment (EEE), nor may it be required for EEE designed and intended as fixed or temporary installation in transportation vehicles such as automobiles, aircraft, and boats. In some European Union member states, these vehicles are considered outside of the scope of the Directive, and EEE for those applications can be considered excluded from the WEEE Directive requirement.



This symbol (WEEE wheelie bin) on product indicates the product must not be disposed of with other household refuse. It must be disposed of and collected for recycling and recovery of waste EEE. Johnson Outdoors Marine Electronics, Inc. will mark all EEE products in accordance with the WEEE Directive. It is our goal to comply in the collection, treatment, recovery, and environmentally sound disposal of those products; however, these requirements do vary within European Union member states. For more information about where you should dispose of your waste equipment for recycling and recovery and/or your European Union member state requirements, please contact your dealer or distributor from which your product was purchased.

ROHS STATEMENT: Product designed and intended as a fixed installation or part of a system in a vessel may be considered beyond the scope of Directive 2002/95/EC of the European Parliament and of the Council of 27 January 2003 on the restriction of the use of certain hazardous substances in electrical and electronic equipment.